

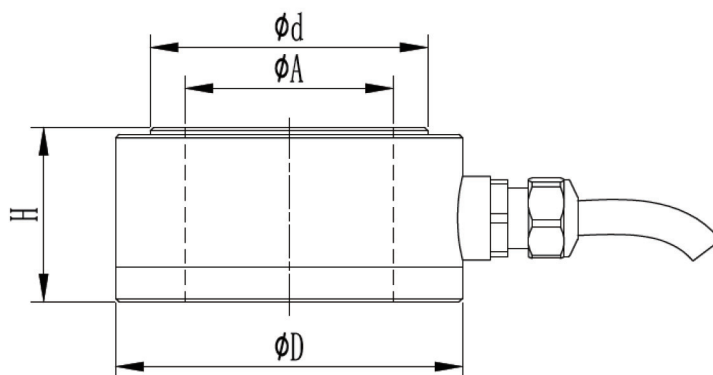

T112

◆ 安装尺寸/Mounting Dimension



◆ 特点与用途/Features & Applications

- 高度低，变形量小
- 不锈钢材料
- 拉压双向
- 汽车压装、自动化组装、3C产品测试、新能源产品组装、医疗检测、机器人领域，模具组装及其他工业测试、测量及控制系统
- 动态响应频率高
- Low profile with small deflection
- Made of stainless steel
- Tension and compression application
- Mainly used for automotive press fit, automated assembly, 3C products testing, new energy product assembly, medical testing, robotics, mold assembly and other industrial testing and control system

	Capacity(kN)	A	H	D	d
M42	1000	43	40	76	66
M39	800	40	30	70	60
M36	700	37	30	65	56
M30	500	31	25	58	48
M24	300	25	25	50	40
M20	200	21	25	44	34
M16	150	16.5	20	38	28
M12	120	12.5	20	35	25
M10	80	10.5	20	30	20
M8	50	8.5	16	26	16
M6	20	6.5	16	22	11

◆ 参数 Specifications 技术指标/Technique

额定容量	Capacity	20,50,80,120,150,200,300, 500,700,800,1000kN
输出灵敏度	Rated output	2.0 ± 20% mV/V
零点输出	Zero balance	± 0.05 mV/V
非线性	Non-linearity	1% F.S.
滞后	Hysteresis	1% F.S.
重复性	Repeatability	1% F.S.
蠕变 (30min)	Creep(30min)	0.05% F.S.
温度灵敏度漂移	Temp.effect on output	0.05% F.S./10°C
零点温度漂移	Temp.effect on zero	0.05% F.S./10°C
输入电阻	Input impedance	385 ± 10 Ω
输出电阻	Output impedance	350 ± 5 Ω
绝缘电阻	Insulation	≥ 5000M Ω/100VDC
激励电压	Recommended excitation	10-26V
最大激励电压	Maximum excitation	20V
温度补偿范围	Compensated temp range	-10-60°C
工作温度范围	Operation temp range	-40-80°C
安全超载	Safe overload	120% F.S.
极限超载	Ultimate overload	150% F.S.
电缆线尺寸	Cable size	Φ3 × 4000mm
单件重量	Weight approx.	0.3kg
材料	Material	Stainless Steel (不锈钢)
防护等级	IP Class	IP66

◆ 受力方式/Load Direction

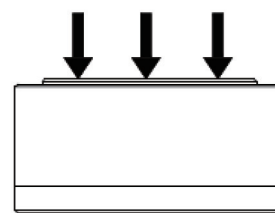

◆ 配线图/ Wiring Code

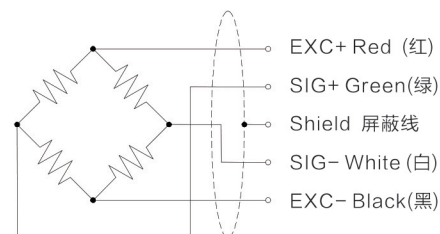

新产品

压向传感器

拉压向传感器

压电力传感器

多维力传感器

称重传感器

张力传感器

螺纹力

扭矩传感器

其它定制力传感器

称重模块

仪表模块放大器